

TERMINAL HORQUILLA

DIN 46237

Voltaje máximo: 600 V.

Temperatura de trabajo:
-40°C a 105°C.

Materiales:
Nylon aislante y horquilla de cobre.

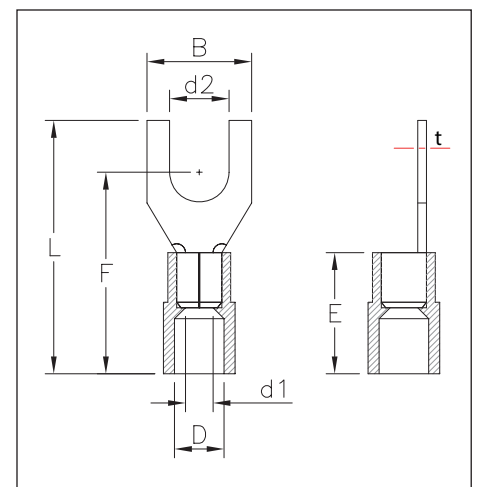
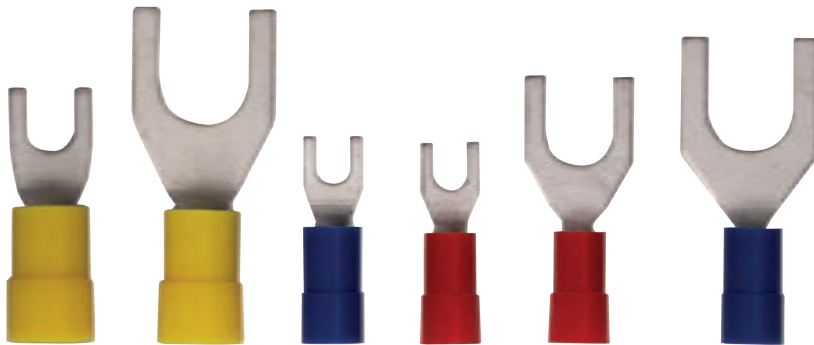

Ø Cable (mm ²)	d2 (mm)	d1 (mm)	B (mm)	F (mm)	L (mm)	E (mm)	D (mm)	t (mm)	Código	10
0,5-1,5	3,2	1,6	6,0	17,0	20,0	11,0	4,1	0,8	90967 401 061	10
	4,3		8,0	18,0	22,0				90967 401 062	
	5,3		10,0	18,0	24,0				90967 401 063	
	6,5		11,0	21,0	26,5				90967 401 064	
1,5-2,5	3,2	2,3	6,0	17,0	20,0	11,0	4,5	0,8	90967 401 071	
	4,2		8,0	18,0	22,0				90967 401 072	
	5,3		10,0	20,0	25,0				90967 401 073	
	6,5		11,0	22,0	27,5				90967 401 074	
	8,4		14,0	23,0	30,0				90967 401 075	
4,0-6,0	4,3	3,6	8,0	21,0	25,0	13,0	6,5	1,0	90967 401 081	
	5,3		10,0	22,0	27,0				90967 401 082	
	6,5		11,0	23,0	28,5				90967 401 083	
	8,4		14,0	26,0	33,0				90967 401 084	